

NTWPA Series power amplifier is our key product adopting complete solid-state solution, featuring with high reliability, friendly interactive user interface, it has been widely used in various applications including wireless telecommunication medical, EMC etc.

- Excellent design, efficient cooling
- Standardized enclosure, easy for cabinet install
- Various protections, high reliability



Product Specifications

Parameters		Performance	Remarks
Working frequency		26.5GHz~40GHz	-
Working Voltage		AC 220V±10% , 50/60Hz	16A*1
Output Power		100W	CW
Max. Input Power		0dBm	CW
Gain		50dB	-
Gain Flatness		±5dB	-
2 nd Harmonic Wave		-20dBc	-
Out-band Spurious		-50dBc	200kHz away from main signal
Fwd-Rev Coupling		-	Support Fwd-Rev coupling coefficient
Protection	Over-VSWR	Alarm activated , PA stops working when output VSWR>3	Alarm activated , PA stops working when output VSWR>3
	Over-heat	70°C	-

Power Amplifier

	Over-heat	-	PA protected from damage when input with large power
Working Temperature		0°C~+40°C	-
Size (L*W*H)		448mm×600mm×450mm	10U
Enclosure Surface Finish		-	Spray paint, sand blast
Input Interface		2.92-K type	Rear panel
Output Interface		BJ320	Rear panel
Fwd-Rev Coupling Interface		2.92-K type	Rear panel
Cooling Unit		-	Forced Air Cooling
Controlling Interface		GPIB、LAN	

Product Exterior Structure

Remark: below drawing for reference only, subject to final drawing

- Front panel

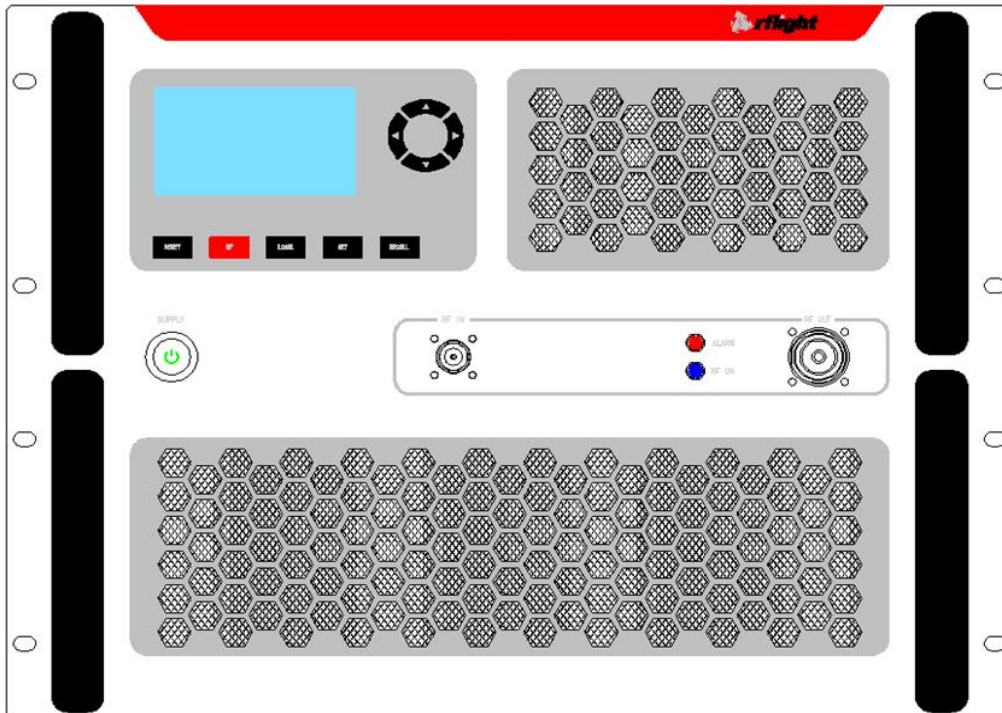

- Rear panel

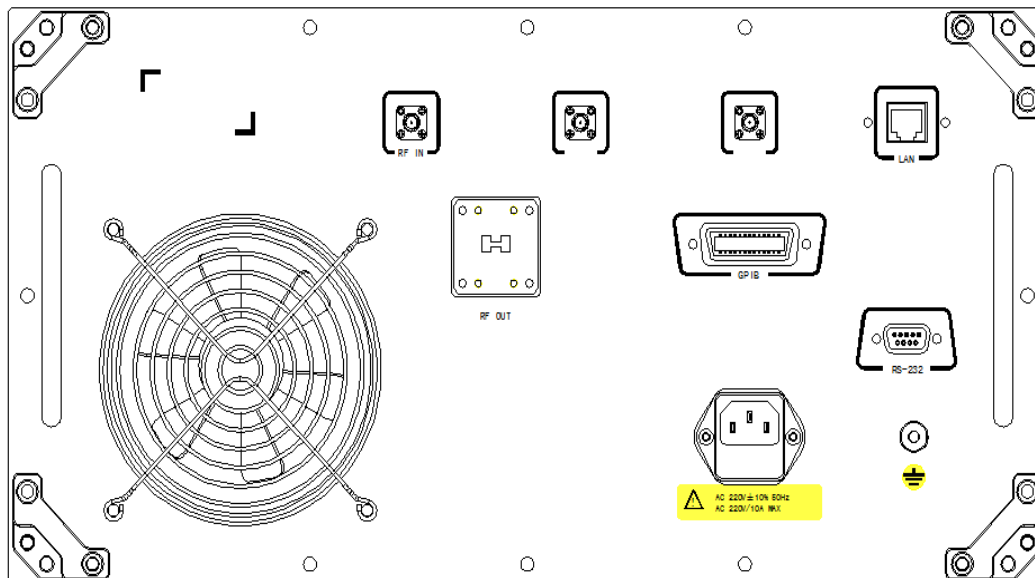

Remark: With continuous product improvement, technical parameters of this document are subject to changes without further notice.