

QWCA-22-K WR-22 to 2.92mm

Features:
* Low VSWR

Applications:
* Wireless
* Transmitter
* Laboratory Test
* Radar

Electrical

Frequency: 32.9-40GHz
VSWR: 1.3 max.
1.2max. (Outline B)
Insertion loss: 0.3dB max.

Mechanical

Coax Connectors: 2.92mm
Waveguide Size: WR-22
Flange: UG-383/U or FBP320
Material: Gold plated brass
Pickled and passivated brass
(Outline B)

How To Order

QWCA-22-X-Y-Z

X : Connector type.

Y : Configuration type.

Z : Flange type if applicable.

Connector naming rules:

K - 2.92mm Male (Outline A, Outline B)

KF - 2.92mm Female (Outline A, Outline B)

Configuration naming rules:

E - End launch

R - Right angle (Outline A, Outline B)

Flange naming rules:

1 - FBP (Outline B)

5 - UG-383/U (Outline A)

Examples:

To order a waveguide to coax adapter, WR-22 to 2.92mm female, right angle, UG-383/U specify QWCA-22-KF-R-5.

Customization is available upon request.

Outline Drawings

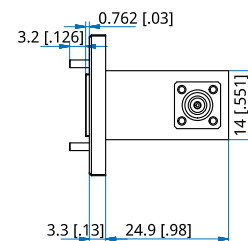
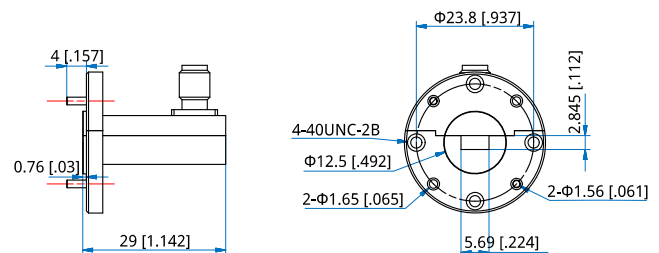

Outline A

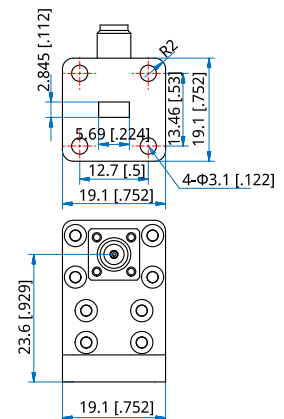
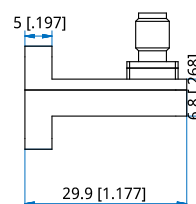

Outline B

Unit: mm [in]

Tolerance: ±0.2mm [±0.008in]